

# GREENE TWP.

1979

ASHTABULA

CO.

TWP.

TWP.

87

87

BLOOMFIELD

MECCA

GUSTAVUS

TWP.

46

11

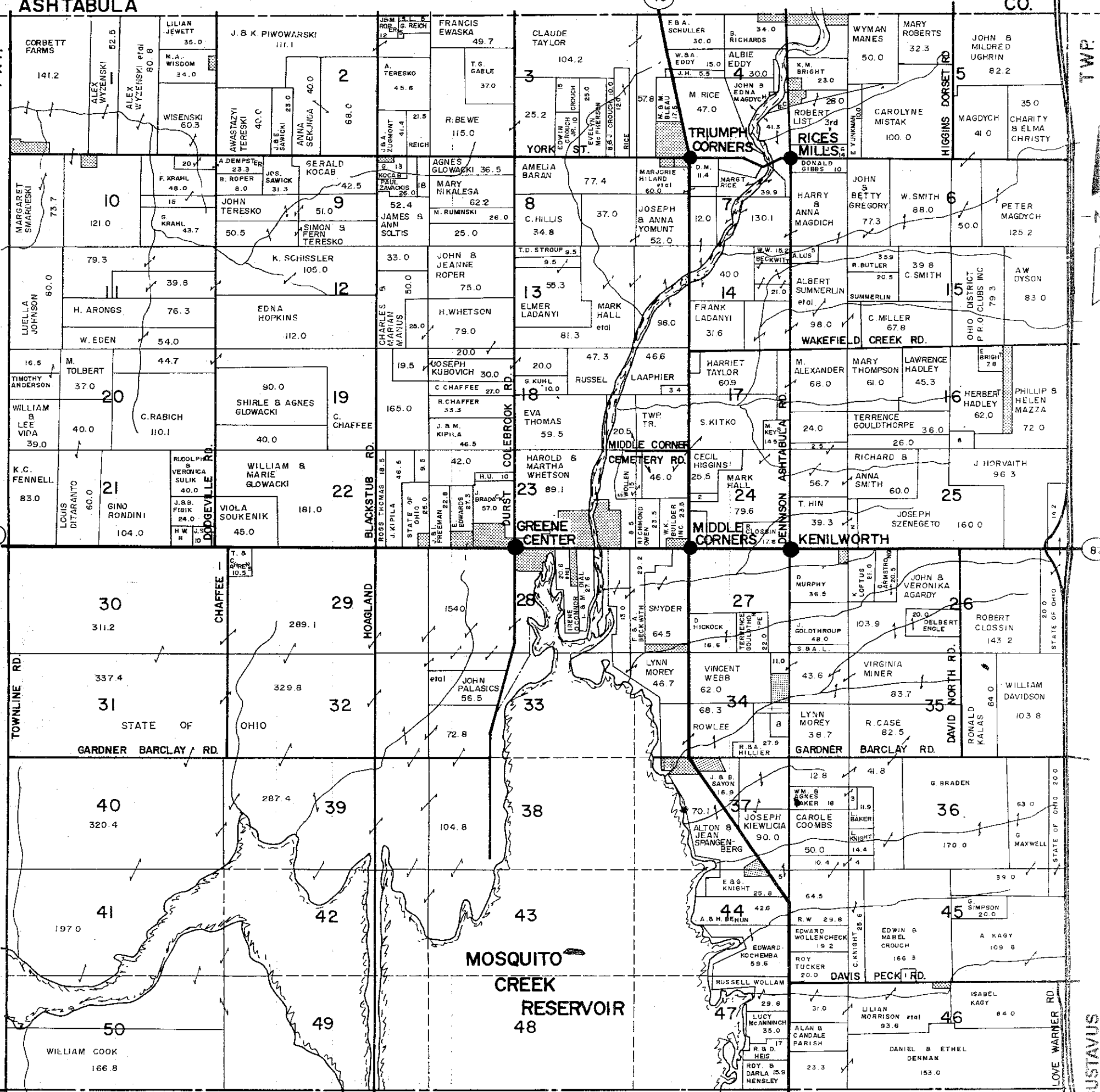

Map content including property names and acreage:

- 141.2 CORBETT FARMS
- 52.5 ALEX WYZENSKI
- 35.0 LILIAN JEWETT
- 34.0 M.A. WISDOM
- 111.1 J. B. K. PIOWARSKI
- 49.7 FRANCIS EWASKA
- 104.2 CLAUDE TAYLOR
- 34.0 F.B.A. SCHULLER
- 30.0 W.S.A. EDDY
- 15.0 J.H. 5.3
- 30.0 ALBIE EDDY
- 23.0 K.M. BRIGHT
- 50.0 WYMAN MANES
- 32.3 MARY ROBERTS
- 82.2 JOHN B. MILDRED UGHRIH
- 45.6 A. TERESKO
- 37.0 T.G. GABLE
- 25.2 R. BEWE
- 115.0 R. BEWE
- 47.0 M. RICE
- 41.3 JOHN B. EDNA MADYCH
- 28.0 ROBERT LIST 3rd
- 100.0 CAROLYNE MISTAK
- 41.0 MAGDYCH
- 35.0 CHARITY & ELMA CHRISTY
- 121.0 MARGARET SMARDESKI
- 48.0 F. KRAHL
- 8.0 B. ROPER
- 31.3 J.C.S. SAWICKI
- 42.5 GERALD KOCAB
- 36.5 AGNES GLOWACKI
- 77.4 AMELIA BARAN
- 60.0 MARJORIE HILAND
- 11.4 D.M. 11.4
- 39.9 HARRY & ANNA MAGDICH
- 77.3 JOHN S. BETTY GREGORY
- 88.0 W. SMITH
- 50.0 PETER MAGDYCH
- 79.3 LUELLA JOHNSON
- 39.8 H. ARONGS
- 76.3 EDNA HOPKINS
- 33.0 JOHN & JEANNE ROPER
- 75.0 H. WHETSON
- 81.3 ELMER LADANYI
- 98.0 MARK HALL et al
- 40.0 FRANK LADANYI
- 31.6 WAKEFIELD D. CREEK RD.
- 98.0 ALBERT SUMMERLIN et al
- 36.9 R. BUTLER
- 20.5 C. SMITH
- 39.8 C. MILLER
- 67.8 C. SMITH
- 83.0 AW DYSON
- 16.5 M. TOLBERT
- 37.0 TIMOTHY ANDERSON
- 44.7 C. RABICH
- 90.0 SHIRLE & AGNES GLOWACKI
- 40.0 C. CHAFFEE
- 165.0 J. CHAFFEE
- 20.0 JOSEPH KUBOVICH
- 30.0 C. CHAFFEE
- 27.0 R. CHAFFEE
- 33.3 J. B. M. KIPILA
- 46.5 EVA THOMAS
- 59.5 S. KITKO
- 20.5 HARRIET TAYLOR
- 60.9 M. ALEXANDER
- 68.0 MARY THOMPSON
- 45.3 LAWRENCE HADLEY
- 62.0 HERBERT HADLEY
- 72.0 PHILLIP & HELEN MAZZA
- 39.0 WILLIAM & LEE VIDA
- 40.0 K.C. FENNEL
- 60.0 LOUIS DITARANTO
- 104.0 GINO RONDINI
- 40.0 VERONICA SULIK
- 40.0 J.B.B. FIBIK
- 24.0 H.W. 8
- 45.0 VIOLA SOUKENIK
- 181.0 WILLIAM & MARIE GLOWACKI
- 42.0 HAROLD & MARTHA WHETSON
- 89.1 H. U. 10
- 46.0 CECIL HIGGINS
- 25.5 MARK HALL
- 79.6 T. HIN
- 39.3 JOSEPH SZENEGETO
- 160.0 J. HORVAITH
- 311.2 CHAFFEE I
- 289.1 HOAGLAND
- 154.0 SNYDER
- 64.5 D. MURPHY
- 36.5 K. LOFTUS
- 21.0 JOHN & VERONIKA AGARDY
- 103.9 DELBERT ENGLE
- 143.2 ROBERT CLOSSIN
- 337.4 STATE OF OHIO
- 329.8 JOHN PALASICS
- 72.8 LYNN MOREY
- 46.7 VINCENT WEBB
- 62.0 D. HICKOCK
- 18.6 J. GOLDTHROUP
- 48.0 S.B.A. L.
- 83.7 VIRGINIA MINER
- 103.8 WILLIAM DAVIDSON
- 31 Gardner Barclay Rd.
- 32 JOHN PALASICS
- 72.8 LYNN MOREY
- 62.0 VINCENT WEBB
- 68.3 ROWLEE
- 38.7 R. CASE
- 82.5 R. CASE
- 64.0 RONALD KALAS
- 103.8 WILLIAM DAVIDSON
- 320.4 STATE OF OHIO
- 287.4 JOHN PALASICS
- 104.8 JOHN PALASICS
- 68.3 ROWLEE
- 38.7 R. CASE
- 82.5 R. CASE
- 64.0 RONALD KALAS
- 103.8 WILLIAM DAVIDSON
- 197.0 STATE OF OHIO
- 41 WILLIAM COOK
- 166.8 JOHN PALASICS
- 104.8 JOHN PALASICS
- 68.3 ROWLEE
- 38.7 R. CASE
- 82.5 R. CASE
- 64.0 RONALD KALAS
- 103.8 WILLIAM DAVIDSON
- 42 WILLIAM COOK
- 166.8 JOHN PALASICS
- 104.8 JOHN PALASICS
- 68.3 ROWLEE
- 38.7 R. CASE
- 82.5 R. CASE
- 64.0 RONALD KALAS
- 103.8 WILLIAM DAVIDSON
- 43 MOSQUITO CREEK RESERVOIR
- 48 WILLIAM COOK
- 166.8 JOHN PALASICS
- 104.8 JOHN PALASICS
- 68.3 ROWLEE
- 38.7 R. CASE
- 82.5 R. CASE
- 64.0 RONALD KALAS
- 103.8 WILLIAM DAVIDSON
- 44 WILLIAM COOK
- 166.8 JOHN PALASICS
- 104.8 JOHN PALASICS
- 68.3 ROWLEE
- 38.7 R. CASE
- 82.5 R. CASE
- 64.0 RONALD KALAS
- 103.8 WILLIAM DAVIDSON
- 45 WILLIAM COOK
- 166.8 JOHN PALASICS
- 104.8 JOHN PALASICS
- 68.3 ROWLEE
- 38.7 R. CASE
- 82.5 R. CASE
- 64.0 RONALD KALAS
- 103.8 WILLIAM DAVIDSON
- 46 WILLIAM COOK
- 166.8 JOHN PALASICS
- 104.8 JOHN PALASICS
- 68.3 ROWLEE
- 38.7 R. CASE
- 82.5 R. CASE
- 64.0 RONALD KALAS
- 103.8 WILLIAM DAVIDSON