

HOWLAND

TOWNSHIP 4 N. RANGE 3 W.

1899

BAZETTA PAGE 33.

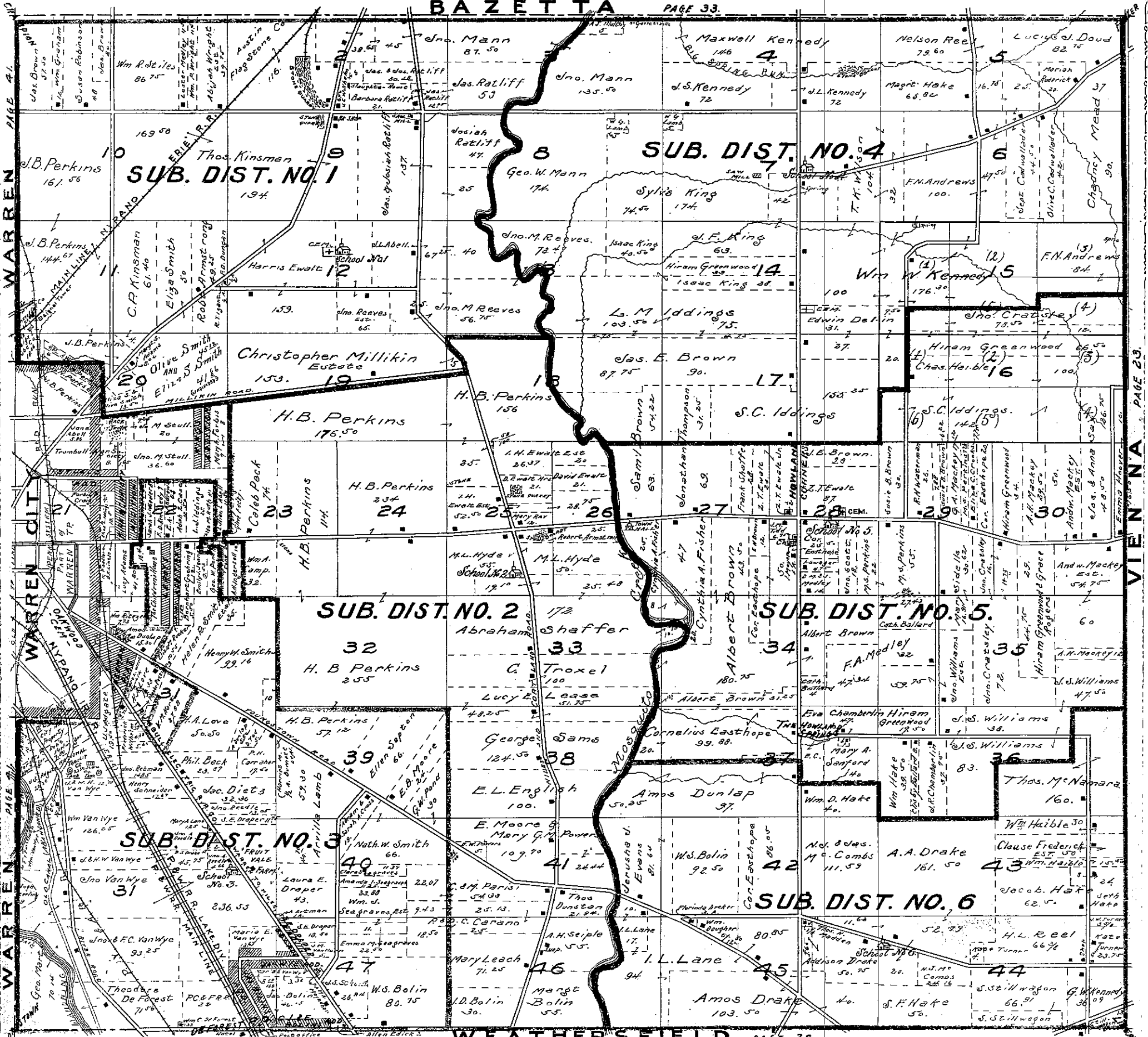

WARREN PAGE 41

WARREN PAGE 41

WEATHERS FIELD PAGE 29

DEFOREST P.O.
 HOWLAND & WEATHERSFIELD
 TOWNSHIPS
 SCALE 400 FT. TO 1 INCH
 3. 27 30. 2.

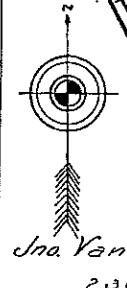

Ina Van Wye
 236.55

Maria E. Van Wye
 13.67
 13.100

S.E. Draper
 (47)
 18.50 a

J.M. Van Horn
 5. a

ELIZABETH ST.
 YAN WYES ADD.

Marie E Van Wye
 3.32
 10.77.73

J.S. Schout

(31)

James Bolin
 46.15

(47)

Property of P.C. & T. R.R. Co.
 22 a.

R & W R.R.
 -SHOPS-

C.L. & E. BOLINS ADD.
 2, 3, 4, 5, 6, 7, 8, 9, 10, 11, 12, 13, 14, 15, 16, 17, 18

Allen Edick
 2nd
 Howland Tp.

W.S. Bolin
 Howland Tp.

TOWN LINE

ROAD

Weatherfield Tp.

JAS. SCHOUTS ADD.
 1, 2, 3, 4, 5, 6, 7, 8, 9, 10, 11, 12, 13, 14, 15, 16, 17, 18, 19, 20, 21, 22, 23, 24

LUCETTA ST.

Eliza M. Heaton

(10)

Jas. S. Schout.
 31.51

(9)

146.30

Nancy De Forest
 6.82